



Winner

**Fire Fighting
Equipment**

Fire Sprinkler

Table of

Contents

Introduction

1. ZST Model Fire Sprinkler
2. Fast Response Fire Sprinkler
- Fusible Alloy Fire Sprinkler
- Open Type Fire Sprinkler
3. ESFR Fire Sprinkler
- Large Scale Fire Sprinkler
4. Water Curtain Nozzle
- Water Mist Spray Sprinkler
- Foam Sprinkler



Quanzhou Winner Fire Fighting Equipment Co.Ltd is the only subsidiary corporation of Huaxia Hose manufacturer for international business. Established in 1985, with over 30 years of producing and quality control experience, we are one of 10 leading and earliest fire fighting equipment in China.

Our main product lines include fire hose, fire hose coupling & nozzle, fire hose reel, fire sprinkler, fire extinguishers and fire fighting equipments ect .

Our Advantages

-28,000 square meter workshop with advanced equipments(more than 350 circular weaving machine,10 more numerically-controlled machine tool, advanced Electrophoresis production line, painting line and hose producing line etc)

-Annual production capacity over 2500,000 m for fire hose.

-Strict quality control (Products have passed ISO9002, MA, ILAC-MRA, AL, CNAS and 3C test from National quality supervision and inspection center of fire-fighting equipment.)

-OEM &ODM service are available to meet any special requirement from customer home and abroad. (We also have our patented products.)

-Brand culture got approved by Fujian province government. (Every certifications can be tracked from their official website.)

-Close to seaport.(One hour reach Xiamen Port.)

That's how we keep value for our customers.

Let's join hands to grow together.





Winner Fire



Fire sprinklers are key parts in automatic water spray extinguishing system. It can be used for detecting fire hazard and put out fire through automatic spray. They widely serve for various civil use, fire security of light or medium degree danger and serious danger protected area in industry and construction.

ZST Model Glass Bulb Fire Sprinkler

ZST glass bulb fire sprinkler consists of glass bulb, copper alloy frame and leak-tightness parts. Sprinkler frame adopts copper alloy with precise forging, high strength and strong erosion proof. Its surface is polished and chrome plated-There are couples of specification and mode ls to be optional. Glass bulb (temperature sensitive unit) and sealing gasket both introduce better import materials with anti-ageing and erosion resistance. Glass bulb is high strength, reliable action and fast response speed.

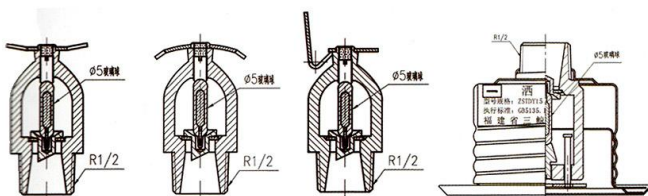

Technical Parameters		
Relatd Operating Temp	Max Ambient Temp	Glass Bulb Temp
57 °C	27 °C	Orange
68 °C	38 °C	Red
79 °C	49 °C	Yellow
93 °C	63 °C	Green
141 °C	111 °C	Blue

Technical Parameters					
Type	Model	Nominal Diameter (mm)	Metal Thread (in)	Flow Coefficient (K)	Instaltion Type
Pendent	T-ZSTX	DN15	1/2	80	Splash Plate Down
		DN20	3/4	115	
Upright	T-ZSTZ	DN15	1/2	80	Splash Plate Up
		DN20	3/4	115	
Sidewall	T-ZSTBS	DN15	1/2	80	Splash Plate Standard
		DN20	3/4	115	
Concealed	ZSTDY	DN15	1/2	80	Splash Plate Down
		DN20	3/4	115	





Winner Fire

Fast Resonse Fire Sprinkler

3mm glass bulb makes this type of fire sprinkler response faster at the same condition of fire scene, preventing fire from growing and reducing losses.

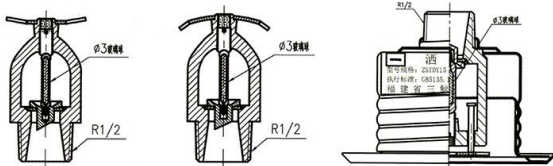

Technical Parameters					
Type	Model	Nominal Diameter (mm)	Metal Thread (in)	Flow Coefficient (K)	Installation Type
Pendent	T-ZSTX	DN15	1/2	80	Splash Plate Down
		DN20	3/4	115	
Upright	T-ZSTZ	DN15	1/2	80	Splash Plate Up
		DN20	3/4	115	
Sidewall	T-ZSTBS	DN15	1/2	80	Splash Plate Standard
		DN20	3/4	115	
Concealed	ZSTDY	DN15	1/2	80	Splash Plate Down
		DN20	3/4	115	



Fusible Alloy Fire Sprinkler

Compared with glass bulb fire sprinkler, this type of sprinkler is smaller and more exquisite. It is less easy to get damaged and more suitable for low temperature work site such as refrigeration storage, warehouse without heat in cold place, underground garage etc.

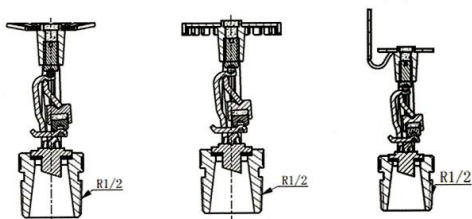

Technical Parameters					
Type	Model	Nominal Dia	Metal Thread	Flow Coefficient	Installation Type
Pendent	Y-ZSTZ15-72C	DN15	R1/2	80	Splash Plate Down
Upright	Y-ZSTX15-72C	DN15	R1/2	80	Splash Plate Up
Sidewall	Y-ZSTBS15-72C	DN15	R1/2	80	Standard



Open Type Sprinkler

Open type sprinklers is a kind of sprinkler without a glass bulb. It is maily used on deluge system.

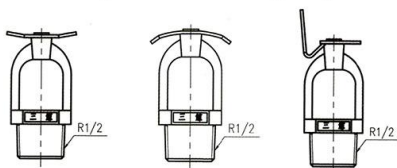

技术参数			
型号规格	接口螺纹	流量系数 (K)	安装形式
ZSTX (K) -15	R1/2	80	下垂型
ZSTZ (K) -15	R1/2	80	直立型
ZSTB (K) -15	R1/2	80	边墙型





Winner Fire

Glass Bulb ESFR Fire Sprinkler

Early suppression fast response sprinkler(ESFR) can work automatically in a predetermined temperature range under the influence of heat. It makes water as a certain shape in density distribution of the protective area to achieve an early effect of fire suppression. 2.5mm glass bulb endows this sprinkler with properties fast response in a short time, high flow, large water drops to deal with high risk of fire situation. It is more suitable for protecting high stacking and goods on high places.

Technical Parameters		
Maximum Indoor Height	Maximum Stack Height	Water Supply Pressure
9.1m	7.6m	0.34MPa
10.7m	9.1m	0.52MPa
12.2m	10.7m	0.52MPa

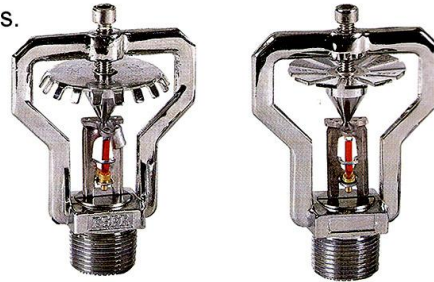
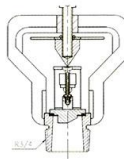

Technical Parameters					
Type	Model	Nominal Dia	Metal Thread	Coefficient	Installation Type
Upright	ESFR-202-68°C U	DN20	R3/4	202	Splash Plate Up
Pendent	ESFR-202-68°C P	DN20	R3/4	202	Splash Plate Down

Fusible Alloy ESFR Fire Sprinkler

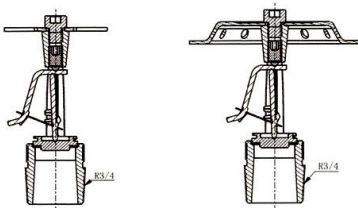

Technical Parameters					
Type	Model	Nominal Dia	Metal Thread	Coefficient	Installation Type
Upright	ESFR-202-72°C P Y	DN20	R3/4	202	Splash Plate Up
Pendent	ESFR-202-72°C U Y	DN20	R3/4	202	Splash Plate Down

QR-EC-HSW115 Large Scale Fire Sprinkler

QR-EC-HSW115 large scale is a key component of automatic fire suppression system widely used in warehouse, plaza, hospital, building etc.

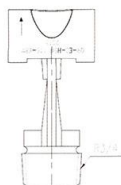

Technical Parameters			
Model	Flow Coefficient	Metal Thread	Installation Type
QR-EC-HSW 115	115 ± 6	R3/4	Splash Plate Standard

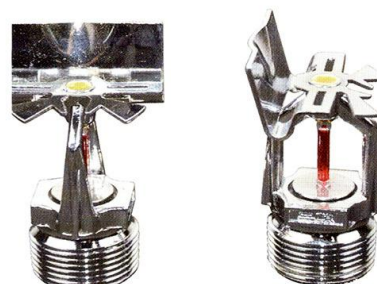



Winner Fire

Water Curtain Nozzle

Water curtain nozzle pressures water distribution into a certain width and thickness like a water curtain to block the flame penetration, absorb heat and separate smoke. Applicable to large factories, workshops, halls, theaters, stage and building doors, windows, openings and other parts or between adjacent buildings.

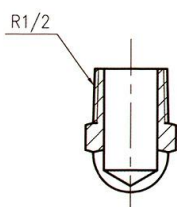

Technical Parameters			
Model	Flow Coefficient (K)	Spray Angle (°)	Metal Thread
ZSTMA-T42-140	42	140 ± 10	R1/2

Water Mist Spray Sprinkler

Water inside this type of sprinkler goes through collision, rotation and stirring, becoming tiny water drops with function of cooling, oxygen starvation, and electric insulation. It is widely used on industrial sites for flammable, combustible gas, liquid processing and storage.

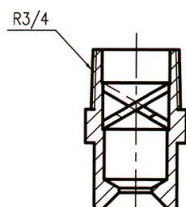
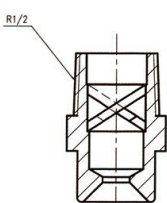

Technical Parameters				
Model	Flow Coefficient (K)	Spray Angle (°)	Metal Thread	Type
ZSTWB-16-90	16	90 °	R1/2	Centrifugal
ZSTWB-34-90	34	90 °	R3/4	Centrifugal

Foam Sprinkler

Technical Parameters					
Model	Working Pressure (Mpa)	Range (Mpa)	Foam Expansion	Flow Coefficient (K)	Protect Range (m)
PT0.7	0.5	0.3 ~ 0.6	≥5	19	3.5

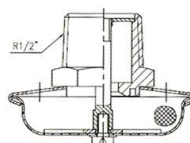



Quanzhou Winner Fire Fighting Co.,Ltd

Add:Chenghui International E-commerce Center,
XiameiTown,Nan'an City,Fujian Province,CN362300

Tel:86-0595-86811911

Fax:86-0595-86811911

Email:info@winnerfirehose.com

www.winnerfirehose.com

winnerfire.en.alibaba.com